

# Series 800 Butterfly Valves

## AWWA C504 Class 150B and 250B

### In Plant / Exposed Service, 24" to 72"

#### Description

The GA Industries Series 800 AWWA Butterfly Valves are rugged, versatile and dependable valves routinely used in water filtration plants, pumping stations, pipelines and power plants to isolate equipment or systems.

These large size Series 800 butterfly valves are standard with a high strength ductile iron body, field replaceable EPDM-P rubber seat in combination with a ductile iron disc with a 316SS seat edge for bi-directional tight shutoff at low and high pressure.

Series 800 exposed service AWWA butterfly valves are available a worm gear with handwheel (optional chainwheel) or 2" nut. Electric motor or pneumatic actuation is also available.

Data Sheet 800.02C



#### Standard Features

- Internal and external epoxy coated, high strength ductile iron body
- EPDM-P rubber seat, field replaceable or adjustable using common tools
- Bi-directional zero leakage seating up to full rated pressure
- Self-adjusting shaft seals
- Integral FA actuator mounting pad, eliminates brackets

#### Standard Materials

- Body Ductile Iron, ASTM A536 Grade 65-45-12
- Body Seat EPDM-P Rubber (Buna-N optional)
- Disc Ductile Iron, ASTM A536 Grade 65-45-12 with 316SS Seat Edge
- Shaft Class 150B: Type 304 SS  
Class 250B: Type 17-4PH SS
- Shaft Bearings Self Lubricating
- External Fasteners Type 316 Stainless Steel

#### Corrosion Protection

- Standard: Internal and External PPG/Amerlok 400 NSF-61 Certified 2-Part Epoxy, Minimum 6 mil DFT

#### Approvals & Certifications

- Fully complies with AWWA Standard C504
- NSF-61 Certified for Contact with Drinking Water
- NSF-372 Certified Lead Free (Max 0.25% Lead Content by Weighted Average)

#### Options and Accessories

- Option CW – With Chainwheel – Facilitates Operation of Overhead Handwheel Operated Valves

#### Ordering Data

- Series 800
- Pressure Class (150B or 250B)
- Size
- Connection (Class 125 flanged)
- Actuator Orientation
- Options/Accessories

Non-Shock Working Water Pressure 33F to 125F (1C to 52C)		
AWWA C504 Pressure Class	Class 150B	Class 250B
Connections	ANSI Class 125 Flanges	ANSI Class 125 Flanges
Operation	Worm Gear with Handwheel or 2" Nut	Worm Gear with Handwheel or 2" Nut
Size	24" to 72"	24" to 72"
Max Working Pressure	150 PSI	250 PSI
Hydro Test	300 PSI	500 PSI

Data Sheet 800.02C

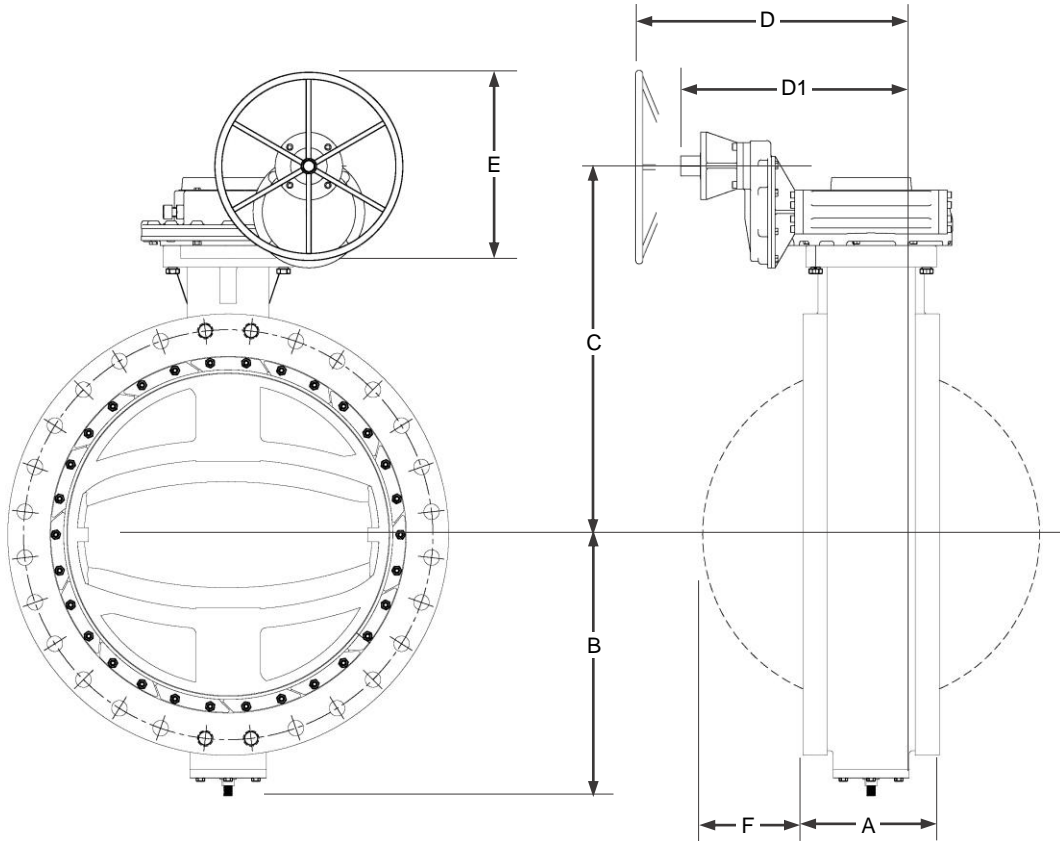

**Worm Gear Installation Dimensions**

SIZE	24"	30"	36"	42"	48"	54"	60"	66"	72"
A	8	12	12	12	15	15	15	18	18
B	17½	23	26¾	29¾	34¾	37¾	41¾	46¾	49¾
C (Max)	27¾	30¾	34½	39¾	43	51½	54½	53¼	57¾
D	Hand Wheel	16½	16½	16½	22	22	24	24	28
D1	2" Nut	14½	14½	14½	20½	20½	22½	22½	26½
E (Dia)	24	24	24	24	32	24	24	32	32
F (Typ)	8	9	12	15	16½	18¼	21¼	23¼	26
WGT	1,225	1,625	2,225	3,335	4,235	5,900	7,450	9,350	11,400

- Dimensions reflect standard worm gear actuator for 150 PSI service. Dimensions C, D and E will differ for other actuators.
- Actuator can be rotated in 90-degree increments about valve centerline
- Dimensions in inches and weight in pounds and are approximate. Request certified drawings if critical.

**Flow Coefficients**

SIZE	24"	30"	36"	42"	48"	54"	60"	66"	72"
C <sub>v</sub>	28,850	42,000	62,000	79,000	108,000	131,355	169,225	212,435	255,885
K	0.38	0.41	0.39	0.44	0.41	0.44	0.40	0.37	0.37