

VALVE DIMENSIONS

SIZE	A		B		C		F		J		K		L	
	IN	MM	IN	MM	IN	MM	IN	MM	IN	MM	IN	MM	IN	MM
30"	51.00	1295	27.60	701	30.25	768	41.50	1054	2.13	54	17.50	445	57.90	1471

PARTS LIST

ITEM NO.	DESCRIPTION
17	ACTUATOR
18	ACTUATOR BOLTS W/ LOCK WASHERS
19	SPACER PLATE

OPTIONAL ACTUATOR POSITIONS;
CUSTOMER TO SPECIFY POSITION WITH ORDER;
POSITION "D" SHOWN IN MAIN VIEW

SEAT
END

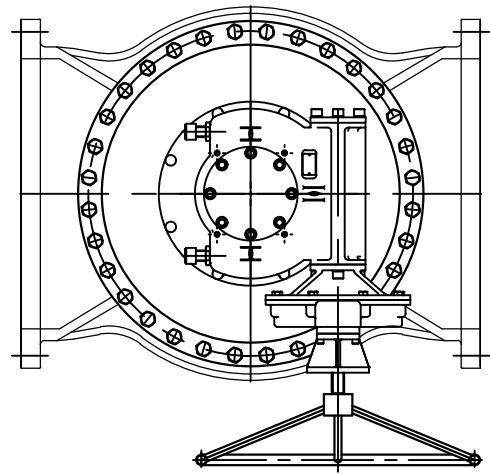

POSITION A (STANDARD)

SEAT
END

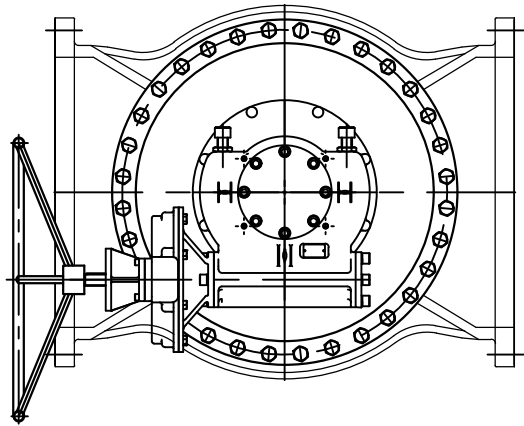

POSITION B

SEAT
END

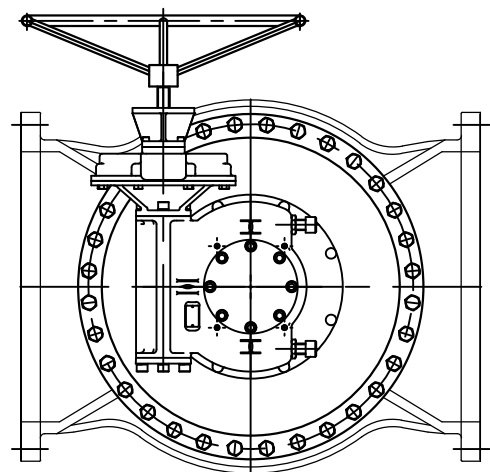

POSITION C

SEAT
END

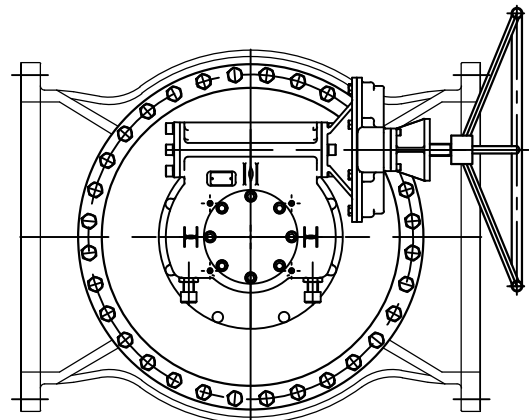

POSITION D

SEAT
END

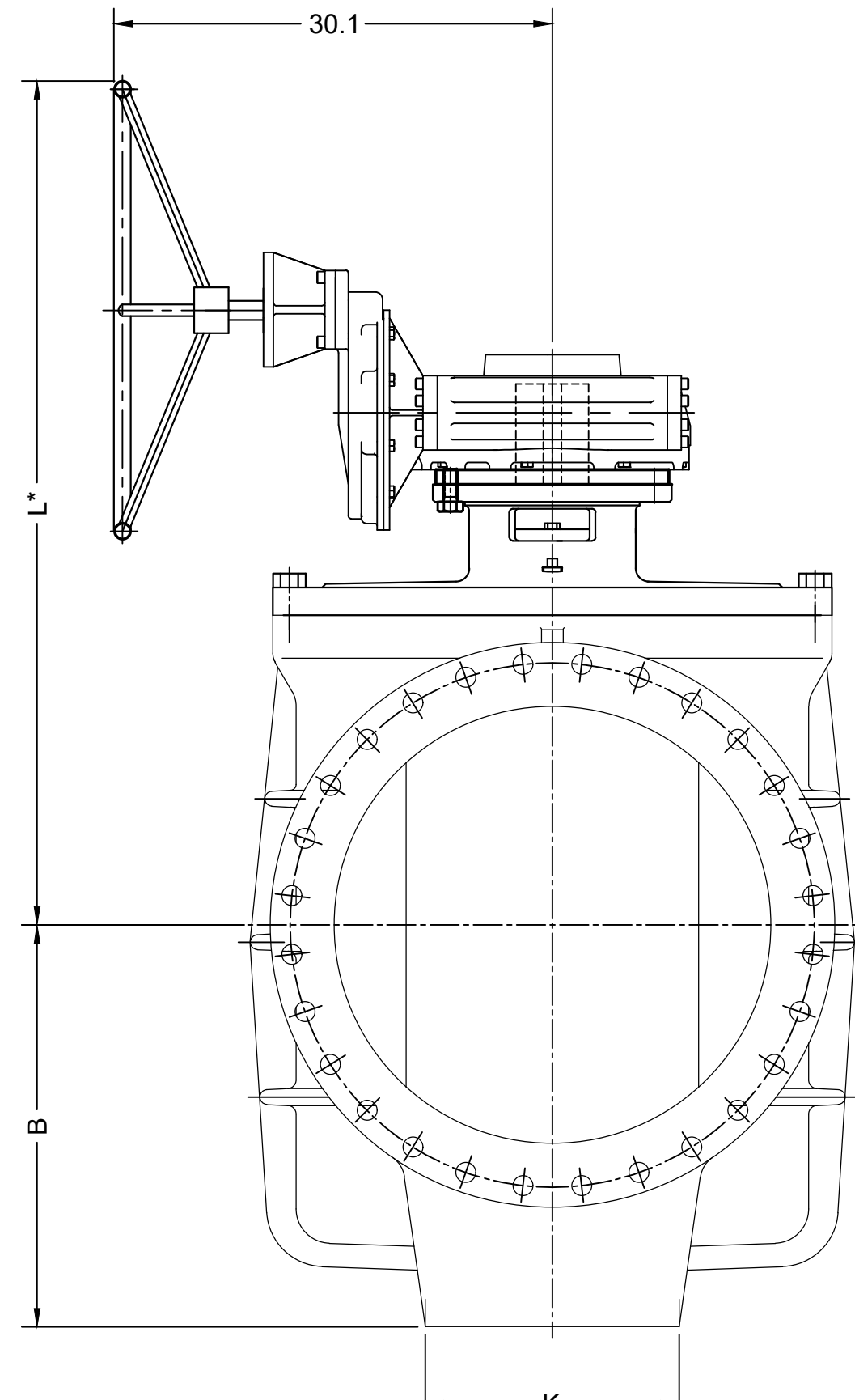
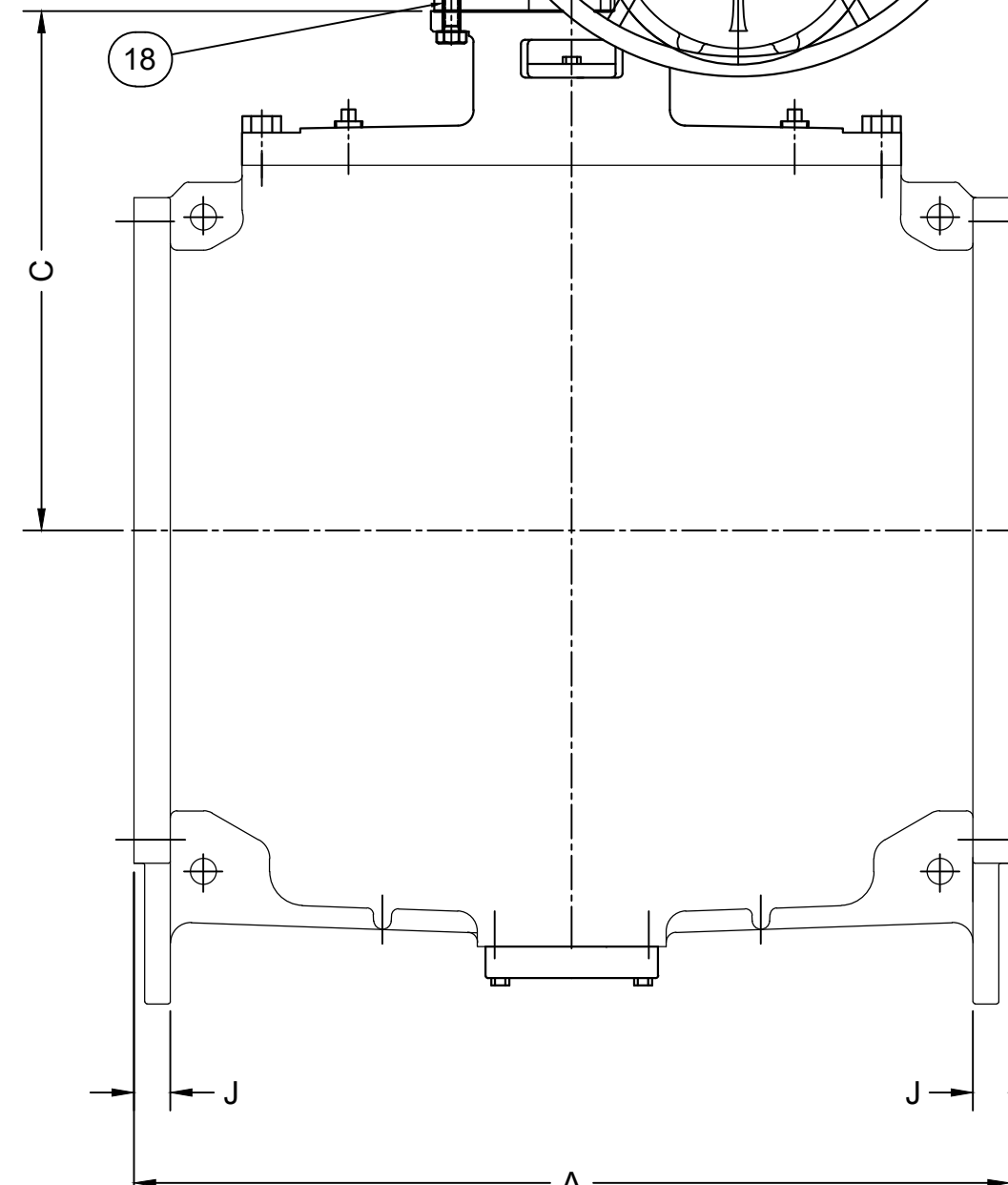
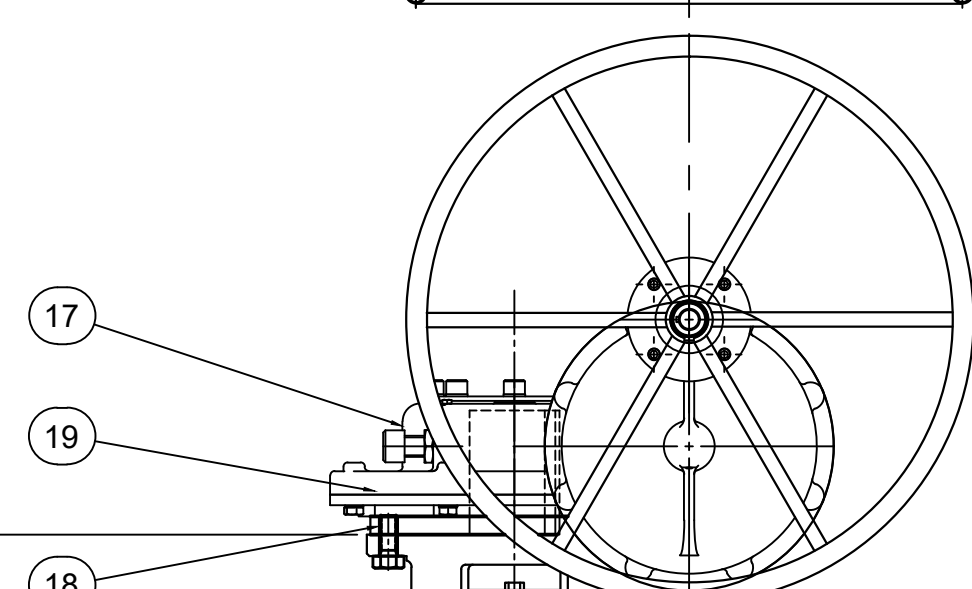
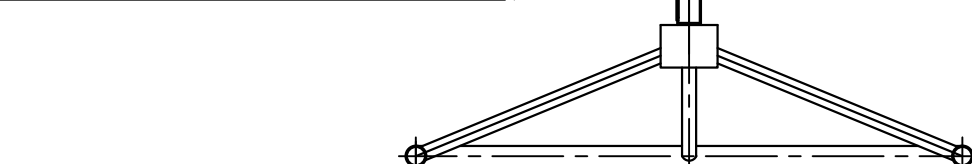
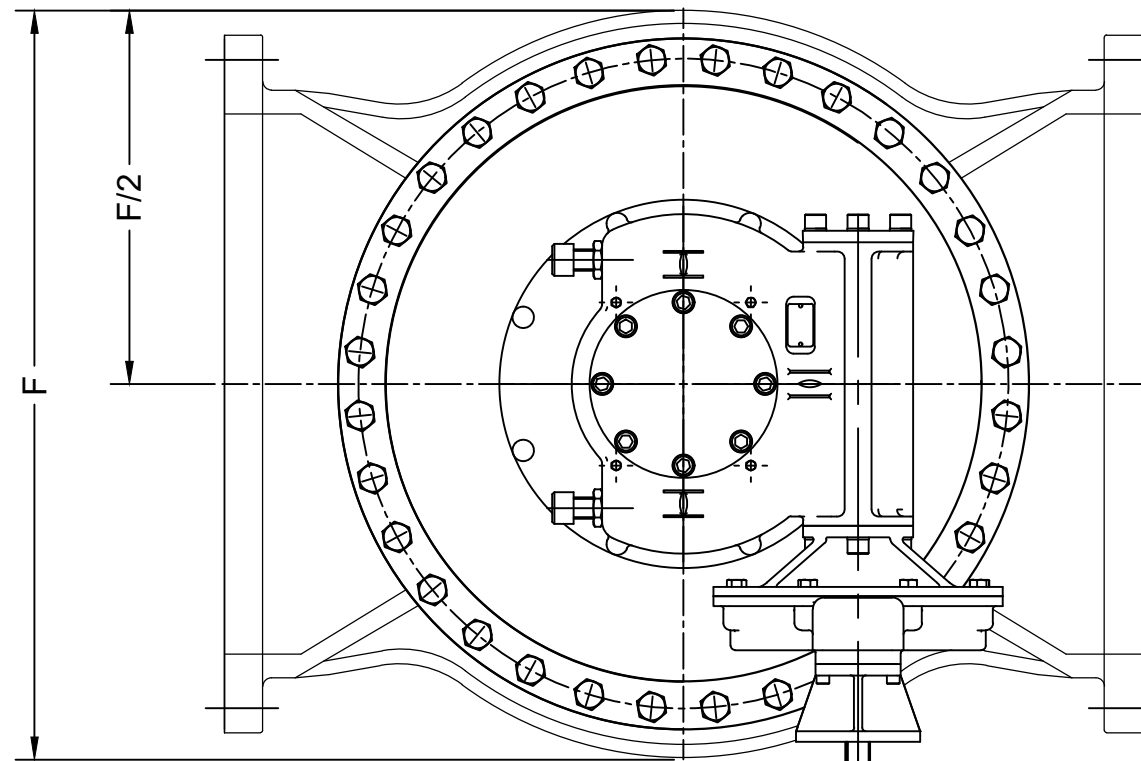

NOTES:

1. FLANGE DRILLING PER ANSI B16.1 CLASS 125
2. IN COMPLIANCE WITH AWWA C517
3. COLD WORKING PRESSURE: 150 PSI
4. HYDROSTATIC TEST PRESSURE: 225 PSI

DIMENSIONS IN INCHES	
STANDARD TOLERANCES (UNLESS OTHERWISE NOTED)	CASTING STOCK MINIMUM (FOR MACHINED SURFACES)
X ± .1	0 TO <1 = 1/8
XX ± .01	1 TO <6 = 3/16
XXX ± .005	6 TO <12 = 1/4
FRACTIONS = ± 1/64	12 AND > = 3/8
ANGLES = ± 1°	
DRAFTS: 3° MAX	
PER ANSI Y14.5M GD&T-3.3.2 FLATNESS, ROUNDNESS, POSITION	

GA INDUSTRIES, LLC
30" 100% RECT. PORT ECO-CENTRIC PLUG VALVE WITH ROTORK #IW8R ACTUATOR
ANSI 125 FLANGE

SERIAL NO.	FIG. NUMBER	DATE	REFERENCES	FILE	DRAWING NO.	REV.
432019073	517	01-05-2017		PL	PL-1143	*

BREAK SHARP EDGES

*NOTE: DIMENSION MAY VARY; REFER TO ACTUATOR DATA TO VERIFY

REV.	DESCRIPTION	DATE	BY

D:\Projects\Engineering\Autocad\Plug\PL-Show\PL-1143.dwg

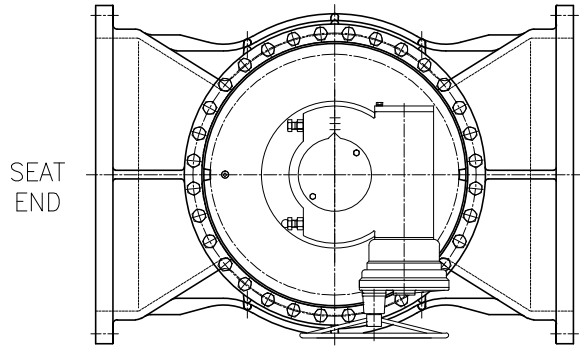

SEAT
END

- NOTES:
 1. FLANGE DRILLING PER ANSI B16.1 CLASS 125
 2. IN COMPLIANCE WITH AWWA C517
 3. COLD WORKING PRESSURE: 150 PSI
 4. HYDROSTATIC TEST PRESSURE: 225 PSI

PARTS LIST	
ITEM NO.	DESCRIPTION
1	BODY
2	PLUG
3	COVER BOLTS
4	COVER O-RING
5	COVER
6	THRUST BEARING
7	BEARING
8	PACKING
9	KEY
10	PLUG BUSHING
11	RETAINING RING
12	RETAINING BOLTS
13	PIPE PLUG
14	END PLATE O-RING
15	END PLATE
16	END PLATE SCREWS
17	COVER MOUNTING FLANGE
18	COVER MTG. FLG. SCREWS
19	WORM GEAR ACTUATOR
20	GEAR ACTUATOR BOLTS

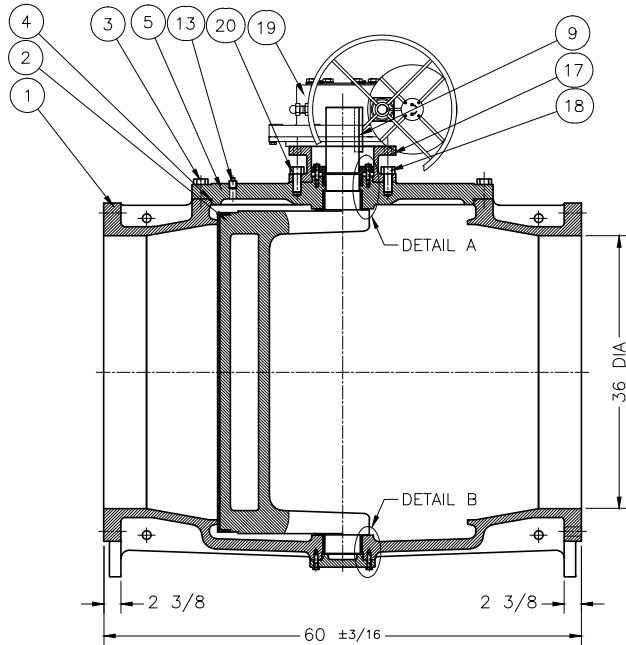

SECTION A-A

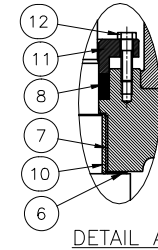
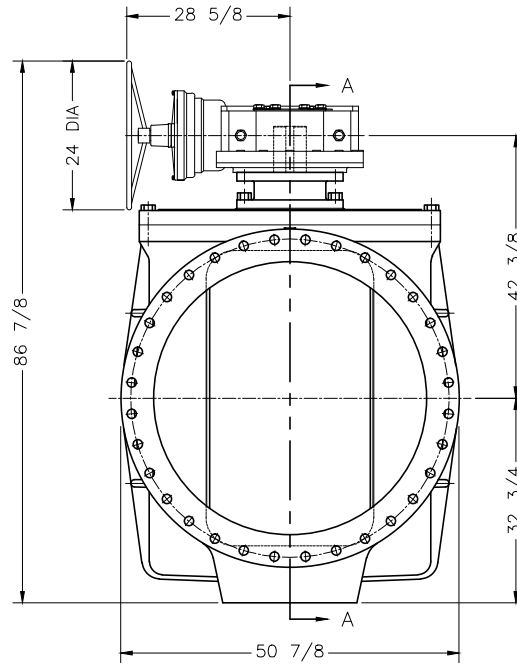

DETAIL A

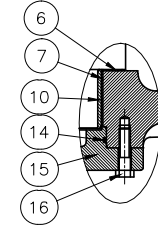

DETAIL B

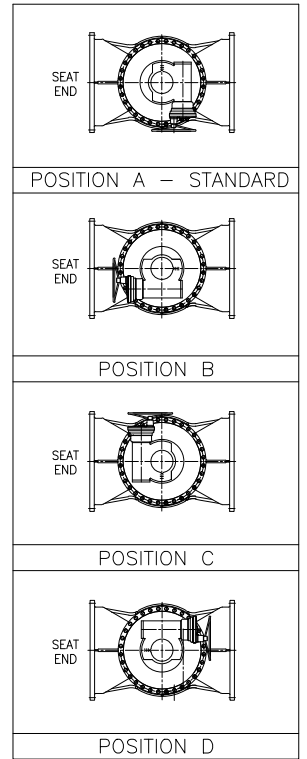

POSITION A - STANDARD

POSITION B

POSITION C

POSITION D

GA INDUSTRIES, LLC		DIMENSIONS IN INCHES		SERIAL NO. *	DRAWN BY
36" ECO-CENTRIC PLUG VALVE		STANDARD TOLERANCES (UNLESS OTHERWISE NOTED)		FIG. NO. 517	APPR. BY JT
WORM GEAR ACTUATOR W/HANDWHEEL		CASTING STOCK MINIMUM (SMALLEST DIM. TO SURFACE)		DATE 02-17-2012	SCALE N.T.S.
ANSI 125 LB FLANGES (100% PORT)		.X = ±.1		PROPERTY OF GA INDUSTRIES, LLC	
		.XX = ±.02		REFERENCES *	FILE
		.XXX = ±.005		PL	DRAWING NO. PL-1071
		FRACTIONS = ±1/64			REV.
		ANGLES = ±1°			
		DRAFTS: 3° MAX			
		PER ANSI Y14.2M GD&T <3/32 FLATNESS, ROUNDNESS, POSITION			

REV.	DESCRIPTION	DATE	BY

J:\AUTOCAD\PLUG VALVE\SHOW PL-1071.DWG