

SIZE	1/2"	3/4"	1"	2"	3"
A	7 <sup>5</sup> / <sub>8</sub> "	7 <sup>5</sup> / <sub>8</sub> "	7 <sup>5</sup> / <sub>8</sub> "	9 <sup>1</sup> / <sub>8</sub> "	10 <sup>1</sup> / <sub>2</sub> "
B	7 <sup>3</sup> / <sub>8</sub> "	7 <sup>3</sup> / <sub>8</sub> "	7 <sup>3</sup> / <sub>8</sub> "	9"	10 <sup>3</sup> / <sub>8</sub> "
C	4"	4"	4"	5 <sup>3</sup> / <sub>8</sub> "	6 <sup>5</sup> / <sub>8</sub> "
WGT	15 lb.	15 lb.	15 lb.	25	45 lb.

PARTS LIST		
Part	Name	Material
1	Figure 930 Air & Vacuum Valve	1/2" to 1" - Drawing EAV-7051W 2" & 3" - Drawing EAV-7052W
2	Figure 905 Air Release Valve	Drawing EAR-7010W
3	Pipe Nipple	Brass

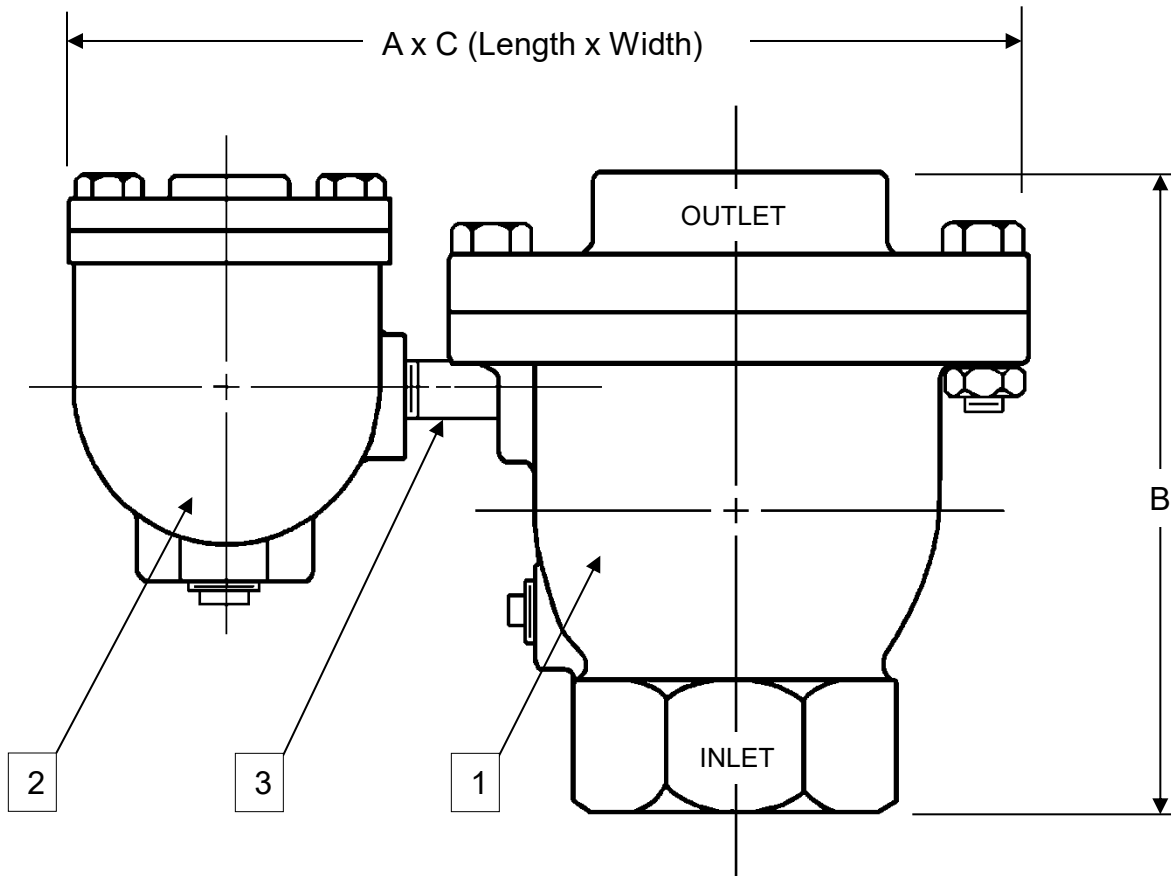

FIGURE NUMBER	MAXIMUM WORKING PRESSURE	PRESSURE RATING	HYDRO TEST PRESSURE
950-T	150 PSI	300 PSI	450 PSI
950H-T	200 PSI	300 PSI	450 PSI

FIGURE 950 AIR VALVES ARE MANUFACTURED AND TESTED IN ACCORDANCE WITH AWWA C512

<b>GA INDUSTRIES</b> <i>a +GF+ Brand</i>		
DATE: 1-14-09	DRAWN BY: WJN	
<b>1/2" to 3" DUAL BODY COMBINATION AIR VALVE</b>		
<b>FIGURE 950-T</b>	DRAWING NO. <b>ECAV-7161W</b>	REV