

SIZE	A	B	BB*	C	WEIGHT, LBS.	
					Class 125	Class 250
6"	21 <sup>5</sup> / <sub>8</sub> "	21"	18"	15 <sup>1</sup> / <sub>4</sub> "	200	220
8"	25 <sup>3</sup> / <sub>8</sub> "	25 <sup>1</sup> / <sub>2</sub> "	20 <sup>1</sup> / <sub>2</sub> "	19"	360	395
10"	29 <sup>7</sup> / <sub>8</sub> "	33"	27"	23 <sup>1</sup> / <sub>2</sub> "	500	555
12"	33 <sup>7</sup> / <sub>8</sub> "	39 <sup>7</sup> / <sub>8</sub> "	32 <sup>1</sup> / <sub>2</sub> "	27 <sup>1</sup> / <sub>2</sub> "	650	730

\* DIMENSION BB IS HEIGHT TO CLASS 125 FLANGED OUTLET CONNECTION (NO COWL)

PARTS LIST		
Part	Name	Material
1	Figure 930 Air & Vacuum Valve	6" to 8" – Drawing EAV-7049-W 10" to 12" – Drawing EAV-7050-W
2	Figure 920 Air Release Valve	Drawing EAR-7003-W
3	Pipe Nipple	Brass

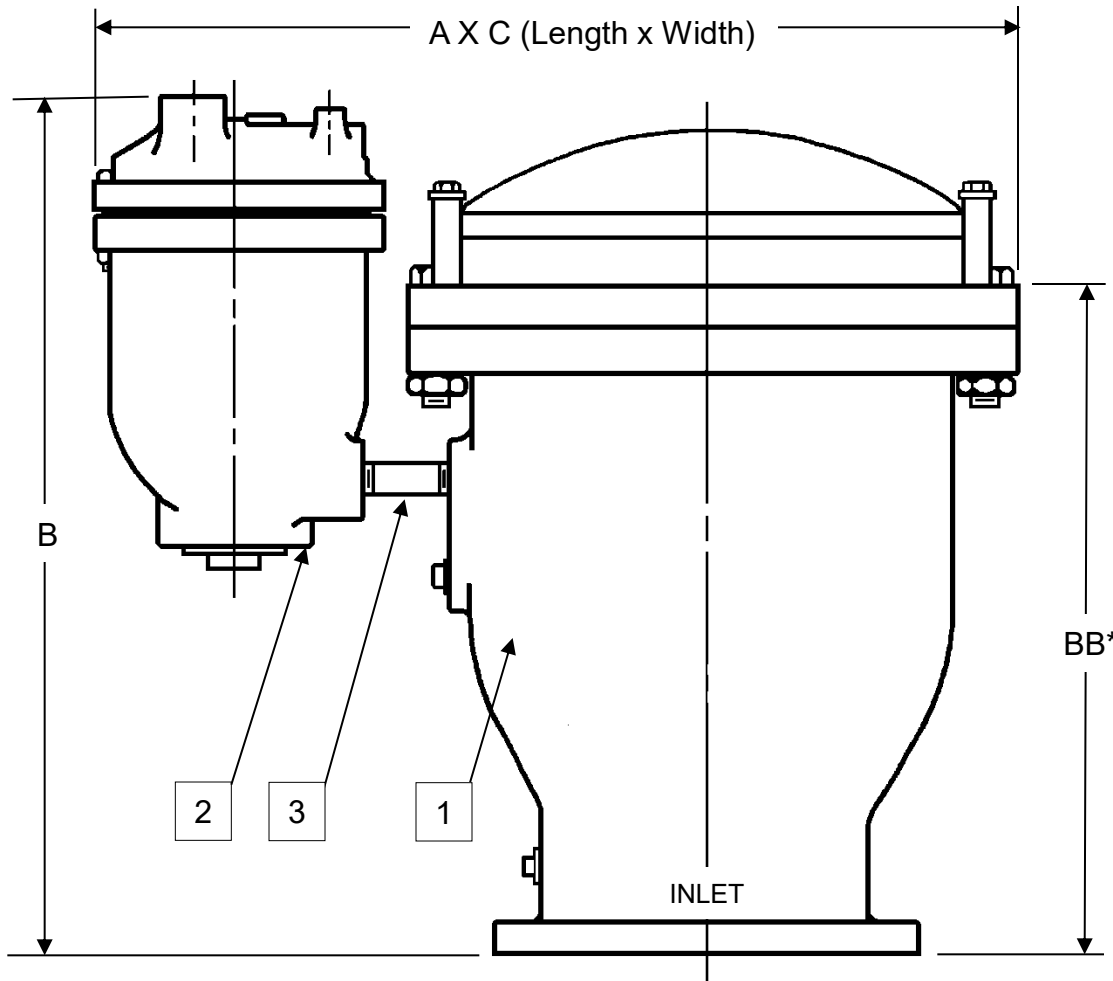

FIGURE NUMBER	INLET FLANGE	OUTLET	MAXIMUM WORKING PRESSURE	PRESSURE RATING	HYDRO TEST PRESSURE
950-DC	ANSI CLASS 125	COWL	150 PSI	200 PSI	300 PSI
950-DJ	ANSI CLASS 125	ANSI CLASS 125			
950H-DC	ANSI CLASS 125	COWL	200 PSI	200 PSI	300 PSI
950H-DJ	ANSI CLASS 125	ANSI CLASS 125			
950H-UC	ANSI CLASS 250	COWL	300 PSI	300 PSI	450 PSI
950H-UJ	ANSI CLASS 250	ANSI CLASS 125			

FIGURE 950 COMBINATION AIR VALVES ARE MANUFACTURED AND TESTED IN ACCORDANCE WITH AWWA C512

<b>GA INDUSTRIES</b> a +GF+ Brand		
DATE:	1-15-09	DRAWN BY: WJN
<b>6" to 12" DUAL BODY COMBINATION AIR VALVE</b>		
<b>FIGURE 950</b>	DRAWING NO. <b>ECAV-7166W</b>	REV <b>B</b>