

SIZE	VALVE DIMENSIONS																NO. OF TAPPED HOLES	WEIGHT IN LBS.		
	A		B		C		D		E		F		G		H SQ.				J	
	IN.	MM	IN.	MM	IN.	MM	IN.	MM	IN.	MM	IN.	MM	IN.	MM	IN.	MM			IN.	MM
3"	8.25	210	7.68	195	10.24	260	11.50	292	14.80	376	0.94	24	3.19	81	2	50.8	9.25	235	0	76
4"	9.08	231	9.13	232	11.22	285	14.25	362	17.12	435	0.98	25	4.25	108	2	50.8	9.25	235	0	115
6"	10.40	264	11.10	282	12.60	320	15.75	400	19.37	492	1.06	27	6.26	159	2	50.8	9.25	235	0	157
8"	13.75	264	13.39	340	17.56	446	17.36	441	26.93	684	1.12	28	8.27	210	2	50.8	11.00	279	0	307
10"	15.00	381	15.71	399	18.82	478	19.37	492	29.33	745	1.18	30	10.24	210	2	50.8	11.00	279	0	435
12"	16.50	419	17.95	456	20.31	516	20.75	527	31.38	797	1.26	32	12.20	210	2	50.8	11.00	279	0	516

PARTS LIST	
ITEM NO.	DESCRIPTION
1	BODY
2	PLUG
3	COVER
4	COVER BEARING
5	BODY BEARING
6	COVER O-RING
7	COVER BOLTS
8	GRIT EXCLUDER SEAL
9	THRUST BEARING
10	BUSHING
11	RETAINING RING
12	U-CUP SEAL
13	KEY
14	GEAR ACTUATOR
15	GEAR ACTUATOR BOLTS

- NOTES:
 1. FLANGE DRILLING PER ANSI A21.1 AWWA C111
 2. IN COMPLIANCE WITH AWWA C517
 3. COLD WORKING PRESSURE: 175 PSI
 4. HYDROSTATIC TEST PRESSURE: 265 PSI
 5. ACTUATOR SUPPLIED IN POSITION A UNLESS SPECIFIED OTHERWISE

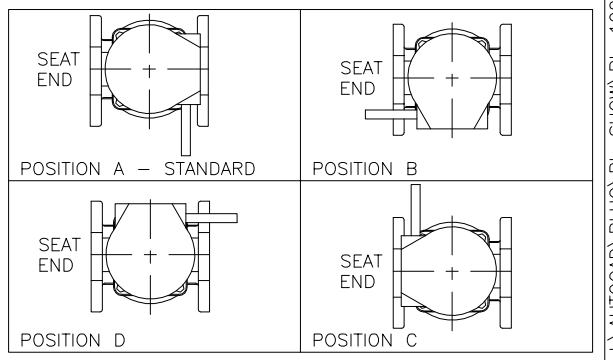
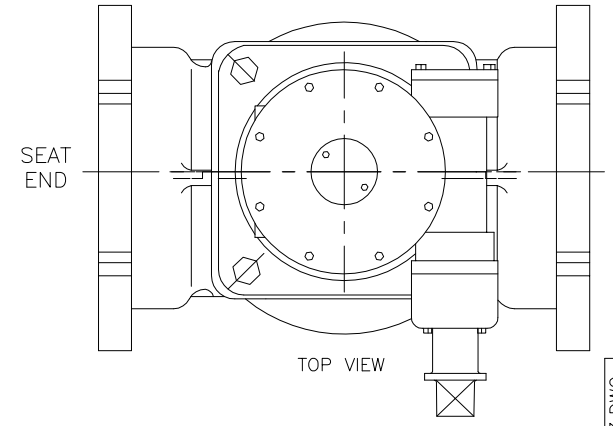
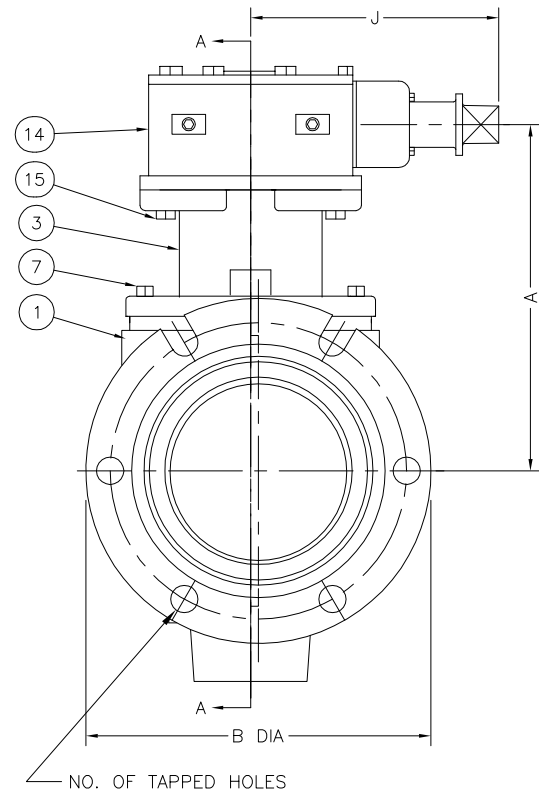
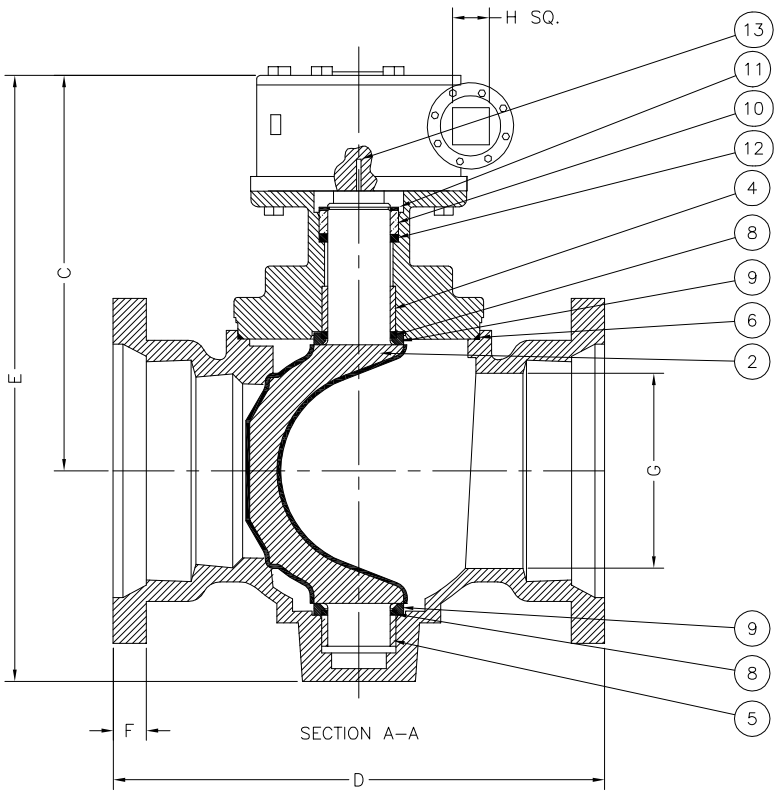

GA INDUSTRIES, LLC

3" - 12" ECO-CENTRIC PLUG VALVE
 BURIED SERVICE W/WORM GEAR ACTUATOR
 MECHANICAL JOINT FLANGES

STANDARD TOLERANCES (UNLESS OTHERWISE NOTED) FINISHED SURFACES ONLY DIMENSIONS SHOWN IN INCHES xx = ±0.02 xxx = ±0.01 xxxx = ±0.005 FRACTIONS ±1/64" ANGLES ±1° FINISH 125-xx RMS	SERIAL NO. *	SCALE N.T.S.	DRAWN BY HGM	
	REFERENCES *	EFFECTIVE DATE 07-17-2009 TO	APPR. BY JT	
	FIG. NUMBER 517	FILE PL	DRAWING NO. PL-1003	REV.

REV.	DESCRIPTION	DATE	BY

J:\AUTOCAD\PLUG\PL-SHOW\PL-1003.DWG