

# Figures 290-D, 290-U Wafer Silent Check Valve

## Description

GA Industries Figures 290-D and 290-U Silent Check Valves are the ideal choice when low cost and non-slam operation are the primary selection criteria for water pumping system check valves. The wafer design is light weight and space-saving .

The valve's internal spring assist and short stroke combine to ensure it is closed before water column reversal thereby preventing the water hammer and system shock that can occur subsequent to a sudden stoppage of pumping.

Sizes 2" to 6" Figure 290-U can be clamped between ANSI Class 125, 150, 250 or 300 flanges while the 8" and 10" Figure 290-D can be clamped between ANSI Class 125 or 150 flanges.

Data Sheet 290.01B



## Standard Features

- Heavy duty cast iron body
- Corrosion resistant 316 stainless steel internal trim
- Zero leakage replaceable rubber O-ring seating
- Suitable for horizontal or vertical flow up installation

## Standard Materials

- Body Cast Iron, ASTM A126 Class B
- Plug Type 316 Stainless Steel
- Seat Ring Type 316 Stainless Steel
- Resilient Seat Buna-N Rubber
- Bushing Type 316 Stainless Steel
- Spring Type 302 Stainless Steel

## Corrosion Protection

- Standard: Uncoated Internal, Enamel Primer External

See Option P2 for upgraded corrosion protection

## Options

- Option P2: Minimum 6 mil Internal and External 2-Part NSF-61 Carboline 891 Epoxy
- Option EP EPDM O-Ring Seal

## Ordering Data

- Figure Number (290-D or 290-U)
- Size
- Options

## Installation Dimensions

SIZE	FIGURE 290-U			FIGURE 290-D			C <sub>v</sub>
	A	B	WGT	A	B	WGT	
2"	4¼	2⅝	5				39
2½"	5	2⅞	7				72
3"	5¾	3⅞	11				130
4"	7	4	18				230
6"	9¾	5½	43				510
8"				13½	6½	91	930
10"				16	8¼	152	1,240

Dimensions in inches, weight in pounds

Non-Shock Working Water Pressure at up to 150F (66C)		
Figure No.	290-U	290-D
Size	2" to 6"	8" and 10"
Max Working Pressure	400 PSI	200 PSI
Hydro Test	600 PSI	300 PSI

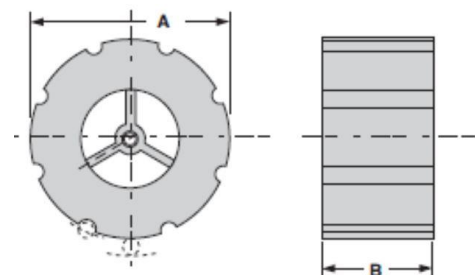

Class 125/150 flange bolts fit in grooves,  
Class 250/300 flange bolts fit outside grooves