

Figures 912, 912H

Simple Lever Air Release Valve

Description

GA Industries Figures 912 and 912H Air Release Valves vent accumulated air while the system is in operation and pressurized. Typically installed at high points where air naturally collects, the valve automatically opens when sufficient air has collected in the valve and closes tightly after the air is released.

In addition to pipeline installations, these high-capacity simple lever valves are also used to release air from the volute of split case pumps, filters and any place where it's necessary to automatically vent accumulated air for efficient operation.

Figures 912 and 912H meet the design, materials of construction and testing required by AWWA C512 and are suitable for use with clean water.

Product Features

- Compact and light weight
- Rugged iron body and cover
- Large venting orifice, releases air faster
- Corrosion resistant Type 316 stainless steel float and internal mechanism
- Tight sealing and easily replaceable rubber seat

Standard Materials

- Body & Cover Cast Iron, ASTM A126 Class B
- Float Stainless Steel, Type 316
- Internal Linkage Stainless Steel, Type 316
- Replaceable Seat Buna-N
- External Fasteners Steel, A307, Zinc Plated
- Coating Internal and External NSF-61 Certified Epoxy

Non-Shock Working Water Pressure at up to 150F (66C)		
Figure No.	912	912H
Connections	NPT	NPT
Inlet Size*	1/2", 3/4", 1"	1/2", 3/4", 1"
Outlet Size	3/8"	3/8"
Orifice Diameter	0.125"	0.094"
Working Pressure	10-150 PSI	10-300 PSI
Pressure Rating	300 PSI	
Hydro Test	450 PSI	
Weight	8 lbs.	

* Valve inlet tapped 1" NPT, smaller sizes accommodated by reducing bushings supplied with the valve



Approvals & Certifications

- Complies with AWWA Standard C512
- NSF-61 Certified for Contact with Drinking Water
- NSF-372 Certified Lead Free (Max 0.25% Lead Content by Weighted Average)

Options/Accessories

- Option BA Build America/Buy America (BABA) and American Iron and Steel (AIS) Compliant
- Option IV Inlet Isolating Valve – lever operated bronze ball valve
- Option SE 316 Stainless Steel External Fasteners
- Option VC: Vacuum Check – prevents air re-entry if internal pressure falls below atmospheric

Ordering Data

- Figure Number (912 or 912H)
- Size
- Options/Accessories

Data Sheet 912.01D

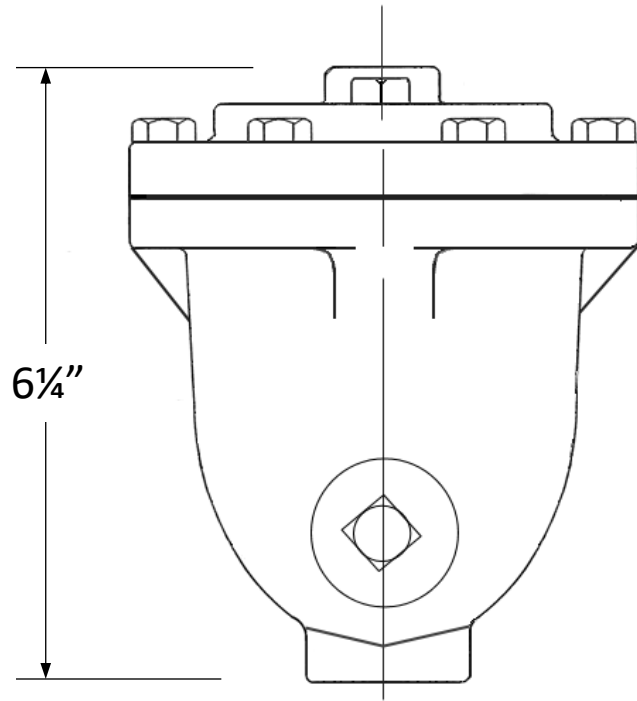
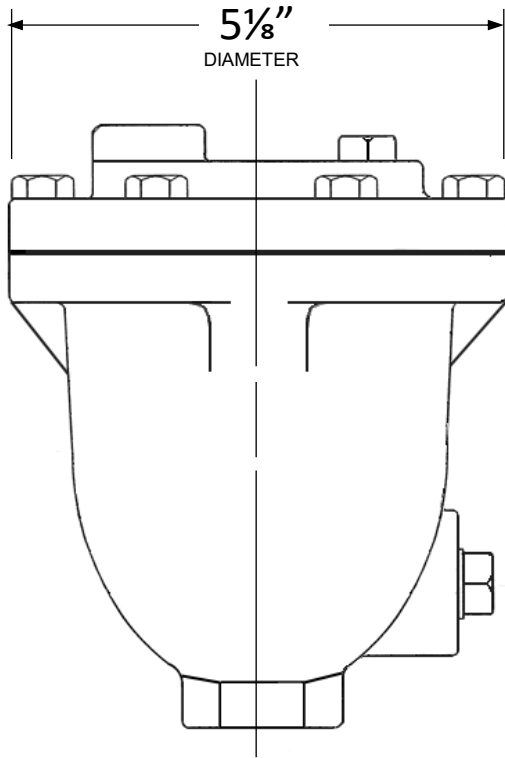

All dimensions and weights are approximate. If critical request certified drawings

Pressure At Valve Inlet	Air Venting Rate, Standard Cubic Feet/Min (SCFM)	
	Figure 912	Figure 912H
10 PSI	3.9	2.2
15 PSI	4.7	2.6
25 PSI	6.3	3.5
50 PSI	10.3	5.8
75 PSI	14.2	8.0
100 PSI	18.2	10.2
150 PSI	26.1	14.7
200 PSI		19.1
250 PSI		23.6
300 PSI		28.0

