

# Figures 927SS, 927SSF, 927SSL, 927SSLF Durovent® All 316 Stainless Steel High-Capacity Sewage/Wastewater Air Release Valve

## Description

GA Industries Figures 927SS and 927SSL automatically and efficiently release air and sewer gas that have collected in the valve while under pressure and operational. Typically installed at high points where air and gas naturally collect, the valve opens when sufficient air and gas has accumulated in the valve and closes tightly after the air and gas has been released.

Whether due to the fluid itself or ambient conditions, Durovent® Wastewater Air Release Valves provide the ultimate in corrosion resistance since the body, cover, float, internal linkage, external fasteners and pipe plugs are all made from Type 316 stainless steel. The valves also employ a specially designed elongated body to maintain the solids bearing fluid far enough below the internal mechanism to minimize clogging and maintenance.

These “high capacity” valves have a larger venting orifice than the standard Figure 925 or 929 air release valves and can release air and gas at a faster rate. They are recommended for systems where the necessary air venting rate exceeds that of a standard valve.

Figures 927F and 927LF include optional “back flushing attachments” to facilitate cleaning sludge and debris from the valve

## Product Features

- Rugged cast 316 stainless steel body and cover
- Compound lever design and extra-large venting orifice combine for higher venting rate
- Corrosion resistant Type 316 stainless steel float and internal mechanism – no plastic components
- Tight sealing and easily replaceable rubber seat
- 2” NPT plugged port to facilitate removal of large debris

Non-Shock Working Water Pressure at up to 150F (66C)		
Figure Nos.	927SSL, 927SSLF	927SS, 927SSF
Connections	NPT	NPT
Inlet Size	2” or 3”	2” or 3”
Outlet Size	1”	1”
Orifice Diameter	0.500”	0.438”
Working Pressure	10-75 PSI	10-150 PSI
Pressure Rating	200 PSI	200 PSI
Hydro Test	300 PSI	300 PSI
Weight	61 lbs.	61 lbs.

## Ordering Data

- Figure Number (927SS, 927SSF, 927SSL or 927SSLF)
- Size
- Options/Accessories

## Data Sheet 927SS.01B



## Approvals & Certifications

- Complies with AWWA Standard C512

## Standard Materials

- Body & Cover Stainless Steel, Type 316
- Float Stainless Steel, Type 316
- Internal Linkage Stainless Steel, Type 316
- Replaceable Seat Buna-N
- External Fasteners Stainless Steel, Type 316
- Pipe Plugs Stainless Steel, Type 316

## Options/Accessories

- Option BA Build America/Buy America (BABA) and American Iron and Steel (AIS) Compliant
- Option FA 316SS Backflush Attachments – inlet isolating valve, ½” flushing valve, 1” blow off valve, quick connect couplings and 5 ft. rubber hose
- Option IV Inlet Isolating Valve – lever operated 316SS ball valve (included with backflush attachments)
- Option US American Iron and Steel (AIS) Compliant
- Option VC: Vacuum Check – prevents air re-entry if internal pressure falls below atmospheric

**Figures 927SS, 927SSF, 927SSL, 927SSLF**  
**Durovent® All 316 Stainless Steel**  
**High-Capacity Sewage/Wastewater Air Release Valve**

Data Sheet 927SS.01B

Pressure At Valve Inlet	Air Venting Rate, Standard Cubic Feet/Min (SCFM)	
	Figure 927SSL	Figure 927SS
10 PSI	62.1	47.5
15 PSI	75.2	57.6
25 PSI	100.6	77.0
50 PSI	163.9	125.5
75 PSI	227.3	174.0
100 PSI		222.5
150 PSI		319.5

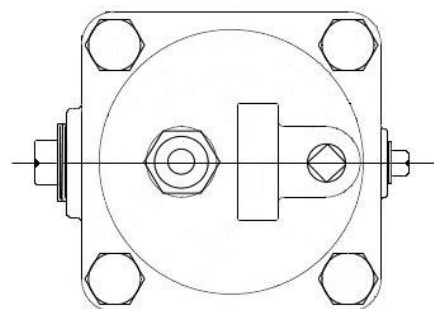

$6\frac{3}{8}"$   
SQUARE

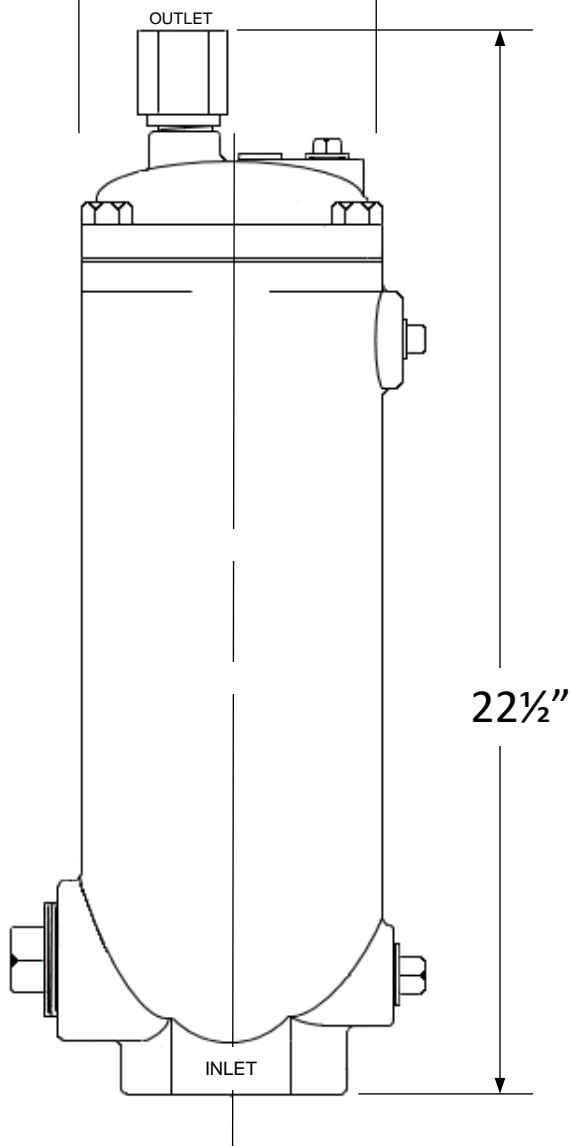

VACUUM CHECK and/or  
INLET ISOLATING BALL  
VALVE

Figures 927SSF and 927SSLF  
With BACKFLUSH  
ATTACHMENTS

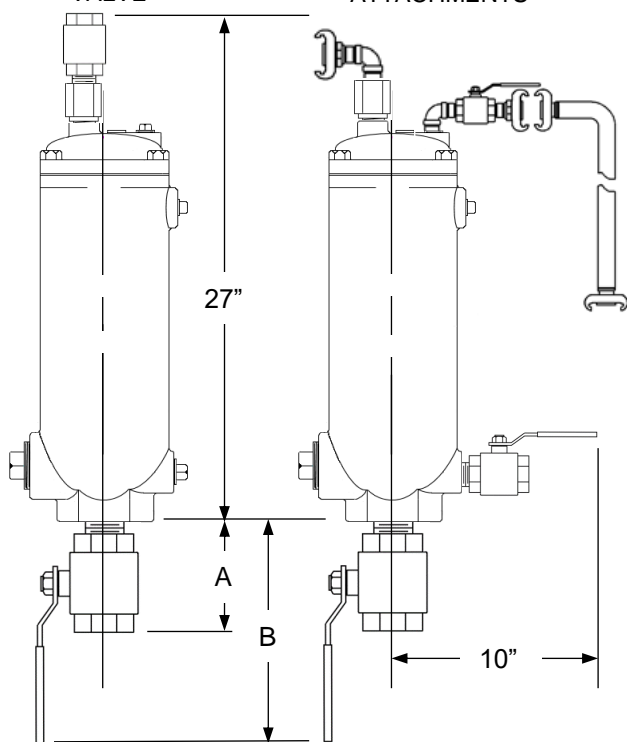

CONNECTION SIZE	2"	3"
A	5"	8"
B	8"	5"
Add for Vacuum Check	1 lb.	1 lb.
Add for Inlet Ball Valve	2 lbs.	8 lbs.
Add for Backflush Attachments	15 lbs.	21 lbs.

All dimensions and weights are approximate. If critical request certified drawings