

# Figures 955-D, 955-DF Dual Body Sewage Combination Air Valve

## Description

GA Industries Figure 955-D Combination Air Valves consist of a Figure 935-D Sewage Air & Vacuum Valve assembled with a Figure 925 Sewage Air Release Valve. Air is vented through the Figure 935's large orifice as the system is filled and then it close tight once the system is full and pressurized. Residual air and gas is released through the Figure 925's small orifice while the system is in operation. The large orifice automatically opens to admit air when the forcemain is drained and/or a negative pressure occurs in the valve.

Figure 955-D are typically installed at system high points where air and sewage gas naturally rise during filling, collect during operation and vacuum first forms during draining. The elongated body is designed to maintain an air gap between the solids bearing fluid and the valve's internal mechanism to minimize fouling and spillage.

Figure 955-DF includes optional "back flushing attachments" to facilitate cleaning sludge and debris from the valve

## Product Features

- Full size large orifice for maximum air outflow and inflow rates
- Small orifice for efficient release of residual air and gas
- Corrosion resistant Type 316 stainless steel float, plug, seat ring and internal mechanism
- Elongated bodies reduce potential for fouling
- Tight sealing and easily replaceable rubber seats

## Standard Materials

- Bodies & Covers Cast Iron, ASTM A126 Class B
- Floats Stainless Steel, Type 316
- Internal Linkages Stainless Steel, Type 316
- Replaceable Seats Buna-N
- External Fasteners Steel, A307, Zinc Plated
- Coating Internal and external NSF-61 certified epoxy



## Approvals & Certifications

- Complies with AWWA Standard C512

## Options/Accessories

- Option BA Build America/Buy America (BABA) and American Iron and Steel (AIS) Compliant
- Option IV Inlet Isolating Valve – lever operated flanged butterfly valve. Note: inlet valve included with backflush attachments.
- Option SE 316 Stainless Steel external fasteners
- Option US American Iron and Steel (AIS) Compliant

## Ordering Data

- Figure Number (955-D, 955L-D, 955-DF, 955L-DF)
- Size
- Options/Accessories

Non-Shock Working Water Pressure at up to 150F (66C)									
	Valve Only				Valve and Backflush Attachments				
Figure Numbers	955-DL		955-D		955-DLF		955-DF		
Inlet Size	4" Class 125	6" Class 125	4" Class 125	6" Class 125	4" Class 125	6" Class 125	4" Class 125	6" Class 125	
Outlet Size	4" NPT	6" NPT	4" NPT	6" NPT	4" NPT	6" NPT	4" NPT	6" NPT	
Air Release Orifice Dia.	0.313"		0.188"		0.313"		0.188"		
Working Pressure	10-75 PSI		10-150 PSI		10-75 PSI		10-150 PSI		
Pressure Rating	200 PSI								
Hydro Test	300 PSI								

# Figures 955-D, 955-DF Dual Body Sewage Combination Air Valve

## Data Sheet 955.02F

### Air Vacuum Orifice

Pressure at Valve Inlet	Air OUTFLOW Rate, Standard Cubic Feet/Min (SCFM)	
	4"	6"
1 PSI	1208	2436
2 PSI	1762	3554
3 PSI	2222	4481
4 PSI	2637	5318
5 PSI	3027	6103

Value is rate at which air is vented from pipeline/system during filling at valve inlet pressures shown. Inlet pressure during filling should not exceed 2 PSI.

### Air Release Orifice

Pressure At Valve Inlet	Air Release Orifice Venting Rate, Standard Cubic Feet/Min (SCFM)	
	955-DL, 955-DLF	955-D, 955-DF
10 PSI	24.3	8.7
15 PSI	29.4	10.6
25 PSI	39.3	14.1
50 PSI	64.0	23.1
75 PSI	88.8	32.0
100 PSI		40.9
150 PSI		58.7

### Air Vacuum Orifice

Pressure at Valve Inlet	Air INFLOW Rate, Standard Cubic Feet/Min (SCFM)	
	4"	6"
-1 PSIG	1275	2870
-2 PSIG	1804	4060
-3 PSIG	2210	4972
-4 PSIG	2551	5741
-5 PSIG	2853	6419

Value is rate at which air is drawn into the valve at negative pipeline/system pressure shown.

### Installation Dimensions

SIZE	4"	6"
A (Square)	9½"	13½"
B	27½"	29"
C	16¾"	18¼"
D	26¾"	28¼"
Valve Weight	260 lb.	390 lbs.
Add for Inlet Isolating Valve Only	45 lbs.	70 lbs.
Add for Backflush Attachments	85 lbs.	110 lbs.

Dimensions and weights are approximate, request certified drawings if critical.

### VALVE ONLY

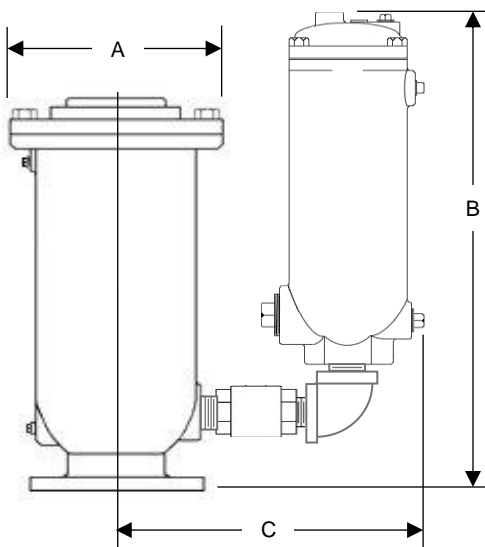

### With INLET ISOLATING VALVE or BACKFLUSH ATTACHMENTS

