

Figure A517-US AIS Compliant 100% Full Port Flow Eccentric Plug Valves for In Plant or Exposed Service

Description

The GA Industries Figure A517-US ECO-centric® Plug Valve is a rugged, field-proven valve that will provide many decades of trouble-free service. Its flow efficient round port provides lower head loss, higher capacity and better solids handling ability than a standard rectangular port plug valve. In addition, the epoxy coated ductile iron body and cover provide superior strength and long-term corrosion resistance while the spherically seating rubber coated plug provides drop tight shutoff in both directions.

Figure A517 exposed service eccentric plug valves are available with a 2" operating nut for quarter turn wrench operation (optional chain lever) or a worm gear with handwheel (optional chainwheel) or 2" nut.

Standard Features

- Internal and external epoxy coated, high strength ductile iron body and cover
- Flow efficient round port, averages 50% less head loss than standard rectangular port plug valves
- Bi-directional zero leakage seating up to full rated pressure
- Self-adjusting U-cup shaft packing
- Upper and lower grit excluders for extended bearing life
- Type 316 stainless steel external fasteners

Standard Materials

- Body and Cover Ductile Iron, ASTM A536 Grade 65-45-12
- Body Seat Weld Overlaid 95% Pure Nickel
- Plug Coating Buna-N Rubber
- Shaft Bearings Stainless Steel, Type 316, Self Lubricating
- External Fasteners Type 316 Stainless Steel

Corrosion Protection

- Standard: Internal and External Carboline 891 NSF-61 Certified Epoxy, min 6 mil DFT

| Non-Shock Working Water Pressure at up to 180F (82C) | | | |
|---|------------------------|------------------------------------|------------|
| Figure Number | A517-US | | |
| Connections | ANSI Class 125 Flanged | | |
| Operation | Lever/Wrench Operated | Worm Gear with Handwheel or 2" Nut | |
| Size | 3" to 8" | 3" to 12" | 14" to 20" |
| Max Working Pressure | 175 PSI | | 150 PSI |
| Hydro Test | 265 PSI | | 225 PSI |

Data Sheet A517.01F



Approvals & Certifications

- Fully complies with American Iron and Steel
- Fully complies with AWWA Standard C517

Options and Accessories

- Option VS Vacuum Service – Suitable for Pro-Cav Pump Suction or Vacuum Sewer Service
- Option CL With Chain Lever – Facilitates Operation of Overhead Direct Nut Valves
- Option CW – With Chainwheel – Facilitates Operation of Overhead Worm Gear Operated Valves

Ordering Data

- Figure Number A517-US
- Size
- Connection (Class 125 flanged)

Flow Coefficients

| SIZE | 3" | 4" | 6" | 8" | 10" | 12" |
|----------------|------|------|------|------|------|------|
| C _v | 569 | 982 | 1997 | 3371 | 4870 | 7643 |
| K | 0.24 | 0.24 | 0.30 | 0.32 | 0.38 | 0.31 |

| SIZE | 14" | 16" | 18" | 20" |
|----------------|------|-------|-------|-------|
| C _v | 8220 | 11300 | 12400 | 17500 |
| K | 0.39 | 0.35 | 0.47 | 0.36 |

Data Sheet A517.01F

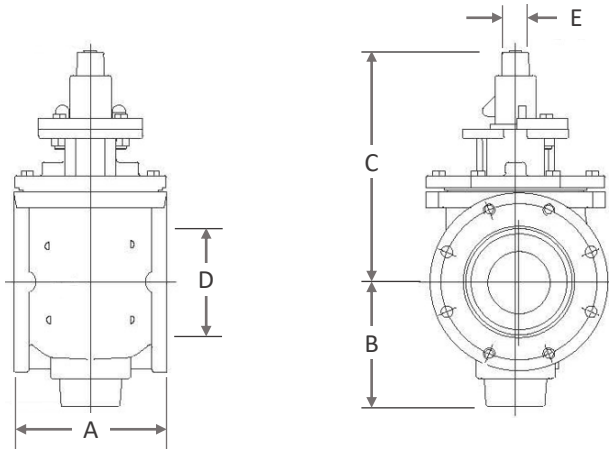

Direct Nut Installation Dimensions

| SIZE | 3" | 4" | 6" | 8" |
|------------|-----|-----|-----|-----|
| A | 8 | 9 | 10½ | 11½ |
| B | 4¾ | 6 | 7 | 9½ |
| C | 11¼ | 12⅞ | 14¼ | 17¼ |
| D (Dia) | 3 | 4 | 6 | 8 |
| E (Square) | 2 | 2 | 2 | 2 |
| WGT | 60 | 90 | 125 | 245 |

Worm Gear Installation Dimensions

| SIZE | 3" | 4" | 6" | 8" | 10" | 12" | 14" | 16" | 18" | 20" |
|---------|----|-----|-----|-----|-----|-----|-----|------|------|------|
| A | 8 | 9 | 10½ | 11½ | 13 | 14 | 17 | 17¼ | 30 | 36 |
| B | 4¾ | 6 | 7 | 9½ | 11 | 11 | 11 | 13 | 16½ | 16½ |
| C | 8¼ | 9 | 10¾ | 13¼ | 15 | 16½ | 17¾ | 19¾ | 19¾ | 21 |
| D (Dia) | 3 | 4 | 6 | 8 | 10 | 12 | 14 | 16 | 18 | 20 |
| E | 9 | 9 | 9 | 10¼ | 10¼ | 10¼ | 15¼ | 15¼ | 15¼ | 19¼ |
| F (Dia) | 12 | 12 | 12 | 12 | 12 | 12 | 20 | 20 | 20 | 20 |
| WGT | 75 | 115 | 150 | 310 | 375 | 515 | 845 | 1010 | 1325 | 2175 |

Worm gear actuator can be rotated in 90-degree increments about valve centerline.
Worm gear actuator can be supplied with 2" operating nut instead of handwheel.
All dimensions in inches and weight in pounds and are approximate. Request certified drawings if critical.

